

**INDEX OF SHEETS**

SHEET ITS 1 ..... TITLE SHEET

SHEET ITS 2A - 2B ..... TYPICAL DETAILS

SHEET ITS 3 - 6 ..... FLASHING BEACONS

SHEET ITS 7 ..... EXISTING DMS INTEGRATION

SHEET ITS 8 - 9 ..... HIGHWAY ADVISORY RADIOS

SHEET SIGN 1 - 4 ..... SIGNING PLANS

STATE OF NORTH CAROLINA  
 DIVISION OF HIGHWAYS  
**NEW HANOVER /  
 BRUNSWICK COUNTIES**

**LOCATION: WILMINGTON AND SURROUNDING AREAS  
 IN NEW HANOVER AND BRUNSWICK COUNTIES**

**TYPE OF WORK: CAPE FEAR MEMORIAL BRIDGE  
 HIGHWAY ADVISORY RADIO SYSTEM**

**LEGEND**

	NEW CONDUIT
	NEW DIRECTIONAL DRILLED CONDUIT
	NEW TYPE 332 HIGHWAY ADVISORY RADIO CABINET
	HIGHWAY ADVISORY RADIO ANTENNA
	NEW WOOD POST
	EXISTING WOOD POLE
	NEW WOOD POLE
	NEW JUNCTION BOX
	ELECTRICAL SERVICE
	FLASHING BEACON SIGN
	NEW BEACON CONTROLLER ASSEMBLY
	EXISTING SIGN GANTRY

**R-4049**

**PROJECT:**

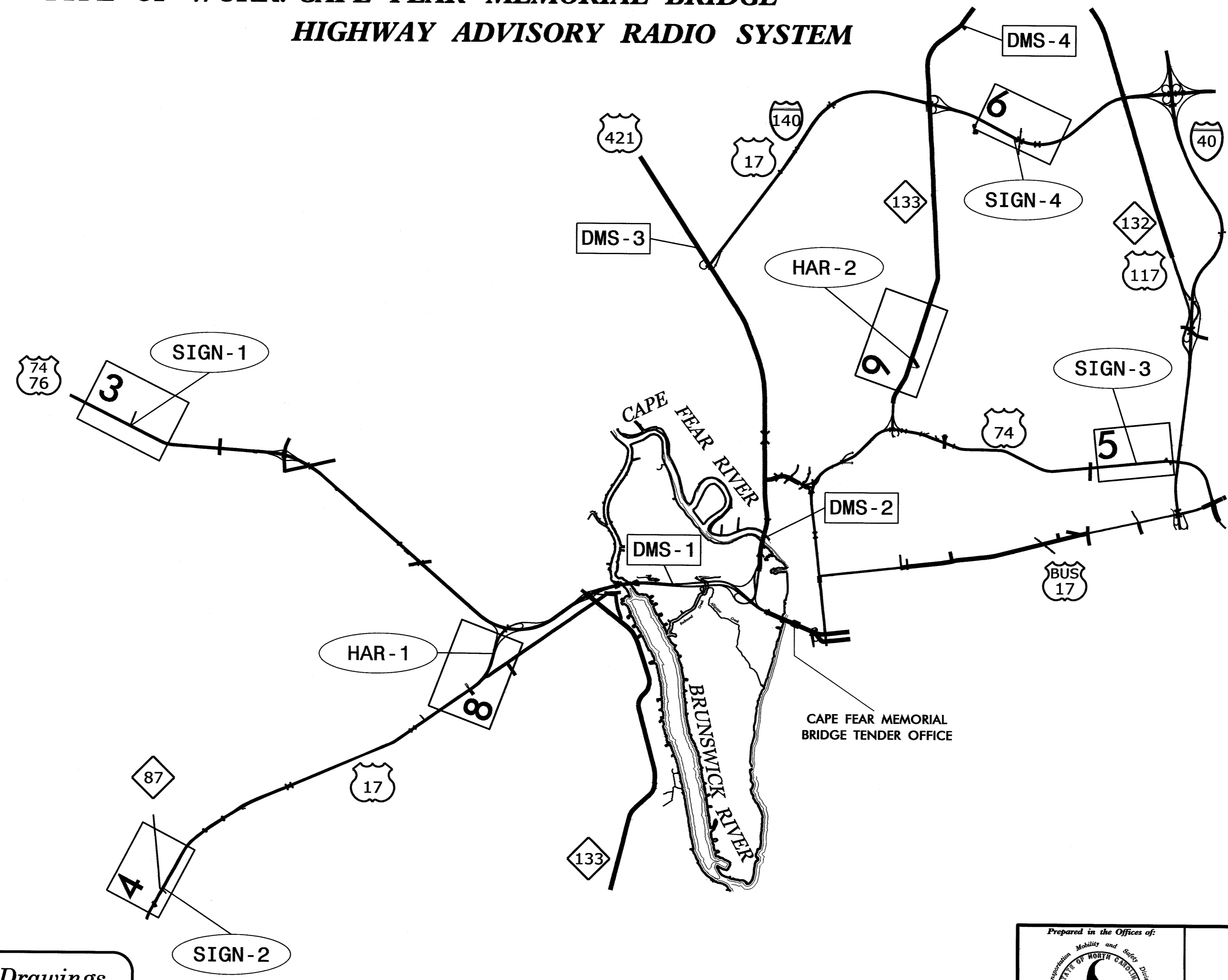

Refer to "Roadway Standard Drawings  
 NCDOT" dated January 2012 and  
 "Standard Specifications for Roads  
 and Structures" dated January 2012.

**NCDOT CONTACT:**  
 TRANSPORTATION MOBILITY AND SAFETY DIVISION  
 G.A. FULLER, PE - STATE ITS AND SIGNALS ENGINEER

 Prepared in the Offices of: Transportation Mobility and Safety Division STATE OF NORTH CAROLINA DEPARTMENT OF TRANSPORTATION 750 N. Greenfield Pkwy., Garner, NC 27529	<b>HIGHWAY ADVISORY          RADIO SYSTEM</b>		
	DIVISION 05 WAKE COUNTY RALEIGH PLAN DATE: APRIL 2012 REVIEWED BY: I.N. AVERY PREPARED BY: S.C. WARDLE REVIEWED BY: G.A. FULLER	REVISIONS INIT. DATE	
Signature: <i>G.A. Fuller</i> 5/9/12 DATE		CAD FILE NAME	

**NOTES**

1. REMOVE BONDING JUMPER IN EQUIPMENT CABINET IF INSTALLED BETWEEN AC NEUTRAL AND EQUIPMENT GROUND.
2. BOND ALL RIGID GALVANIZED STEEL CONDUITS ENTERING THE CABINET TO "EQUIPMENT GROUND".
3. ENSURE EQUIPMENT GROUND IS ELECTRICALLY BONDED TO CABINET.

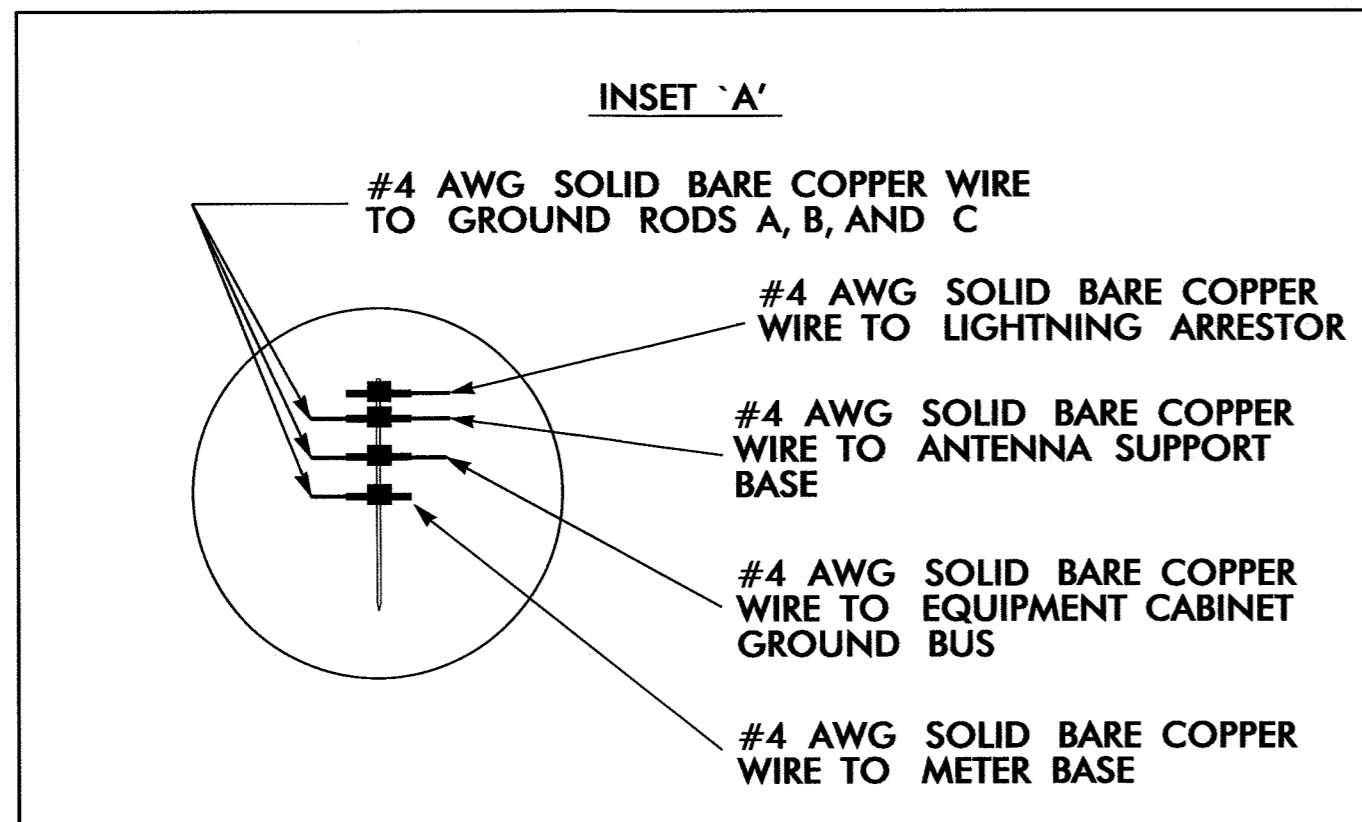
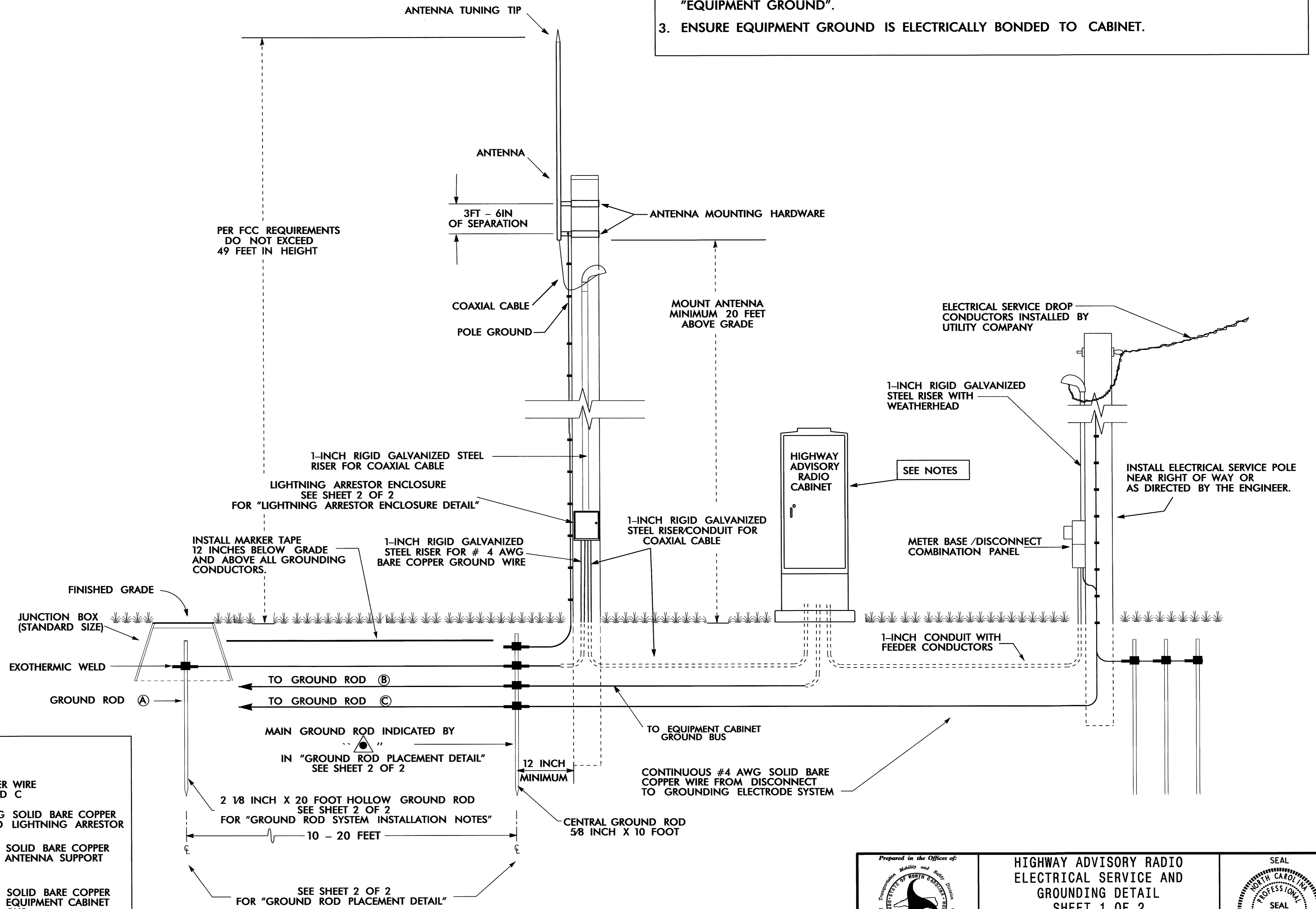

<p>750 N. Greenfield Pkwy., Garner, NC 27529</p>	<p><b>HIGHWAY ADVISORY RADIO ELECTRICAL SERVICE AND GROUNDING DETAIL</b></p> <p>SHEET 1 OF 2</p>			
	<p>DIVISION 03 NEW HANOVER CO. WILMINGTON</p>	<p>PLAN DATE: APRIL 2012 REVIEWED BY: I.N. AVERY</p>		<p>PREPARED BY: S.C. WARDLE REVIEWED BY: G.A. FULLER</p>
	<p>SCALE: 0</p>	<p>REVISIONS</p>		<p>INIT. DATE</p>

Signature: *Gregory A. Fuller* 5/9/12

### SUPPLEMENTAL GROUND ROD SYSTEM INSTALLATION NOTES

1. AUGER A 6" WIDE BY 20' DEEP HOLE FOR GROUND ROD PLACEMENT.
2. REMOVE PROTECTIVE TAPE AT THE BOTTOM OF THE GROUND ROD PRIOR TO INSTALLING GROUND ROD IN AUGERED HOLE.
3. INSTALL GROUND ROD (2 1/8" BY 20') HOLLOW TUBE, TYPE "K" COPPER, WITH 0.083" WALL THICKNESS.
4. FILL VOID AROUND OUTSIDE OF GROUND ROD WITH BENTONITE CLAY SLURRY
5. REMOVE PROTECTIVE TAPE AT THE TOP OF THE GROUND ROD ONCE THE BENTONITE CLAY SLURRY IS INSTALLED.
6. FILL INSIDE OF HOLLOW GROUND ROD WITH NON-HAZARDOUS CALSOLYTE MIXTURE.
7. EXOTHERMICALLY WELD PIGTAIL TO #4 AWG BARE COPPER WIRE.
8. INSTALL JUNCTION BOX (STANDARD SIZE) OVER TOP OF GROUND ROD.
9. TEST GROUND ROD SYSTEM IN ACCORDANCE WITH HAR SYSTEM REQUIREMENTS.

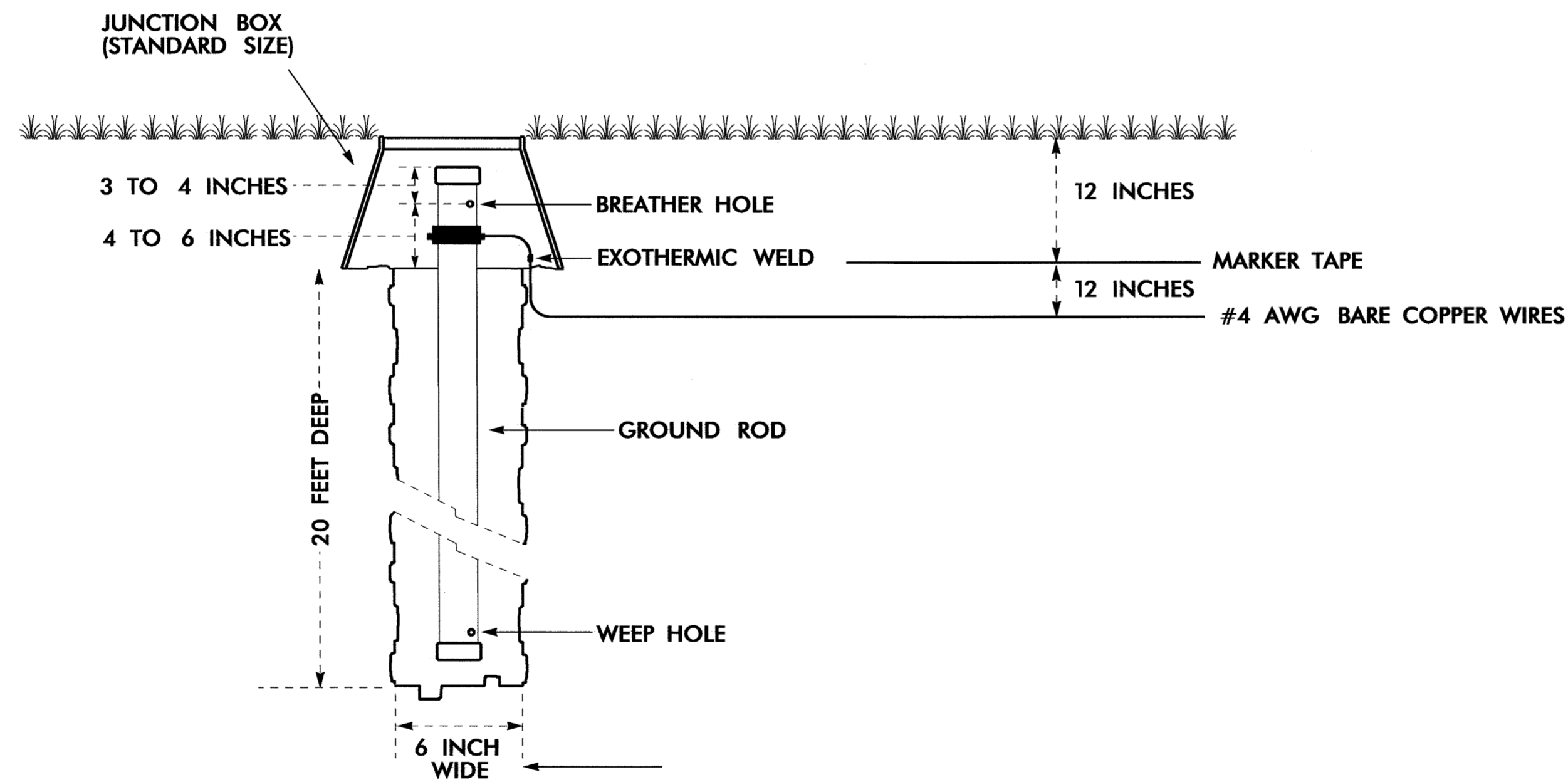

### TRIAD GROUND ROD PLACEMENT DETAIL (TYPICAL EACH POLE)

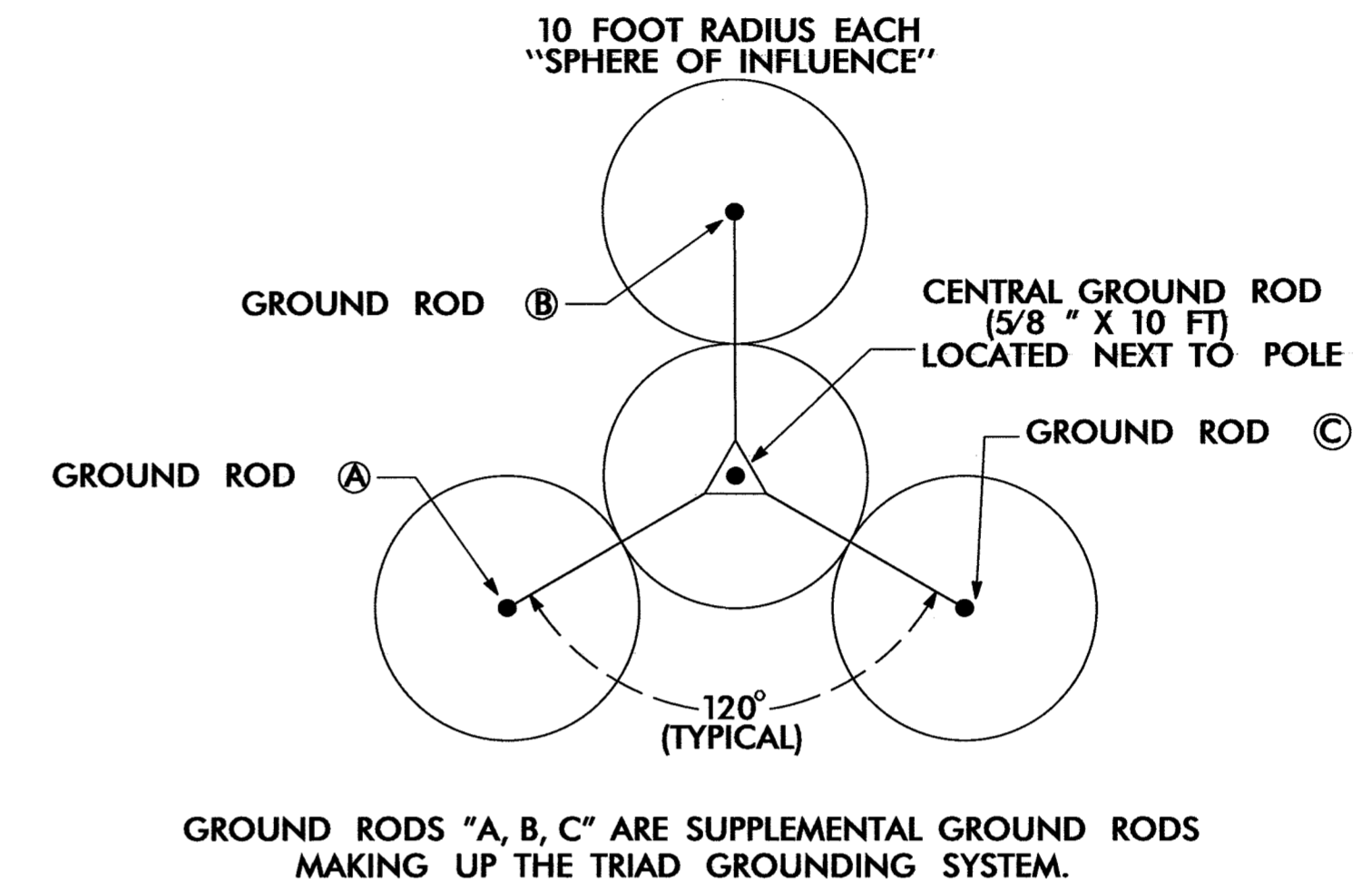

### LIGHTNING ARRESTOR ENCLOSURE DETAIL

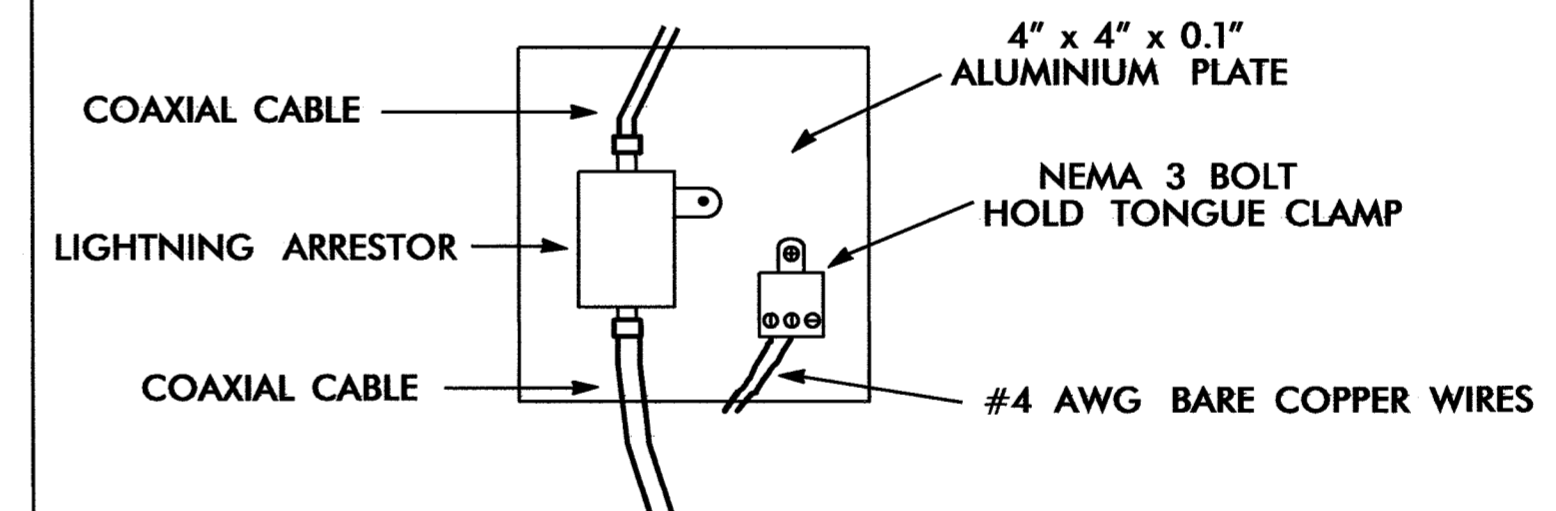

	<b>HIGHWAY ADVISORY RADIO ELECTRICAL SERVICE AND GROUNDING DETAIL</b> SHEET 2 OF 2		SEAL PROFESSIONAL ENGINEER GREGORY A. FULLER SEAL 023919
	DIVISION 03 NEW HANOVER CO. WILMINGTON		
PLAN DATE: APRIL 2012	REVIEWED BY: I.N. AVERY		PREPARED BY: S.C. WARDLE REVIEWED BY: G.A. FULLER
SCALE: 0	REVISIONS	INIT. DATE	
Signature: <i>Gregory A. Fuller</i> 5/9/12 DATE			SEAL

INSTALL THE FOLLOWING	
QUANTITY	DESCRIPTION
1	WOOD POST (6" x 6")
100'	UNPAVED TRENCHING (1) (2")
30'	UNPAVED TRENCHING (1) (1.25")
200'	DIRECTIONAL DRILL (1) (2")
2	JUNCTION BOX (STANDARD SIZE)
1	ELECTRICAL SERVICE
2	2" CONDUIT STUB-OUT FOR UNDERGROUND ELECTRICAL SERVICE
330'	FEEDER CONDUCTOR (2-WIRE #8 AWG /1-WIRE #4 AWG THWN COPPER)
1	BEACON CONTROLLER ASSEMBLY - 120V AC
2	12", 1 SECTION AMBER FLASHING BEACON

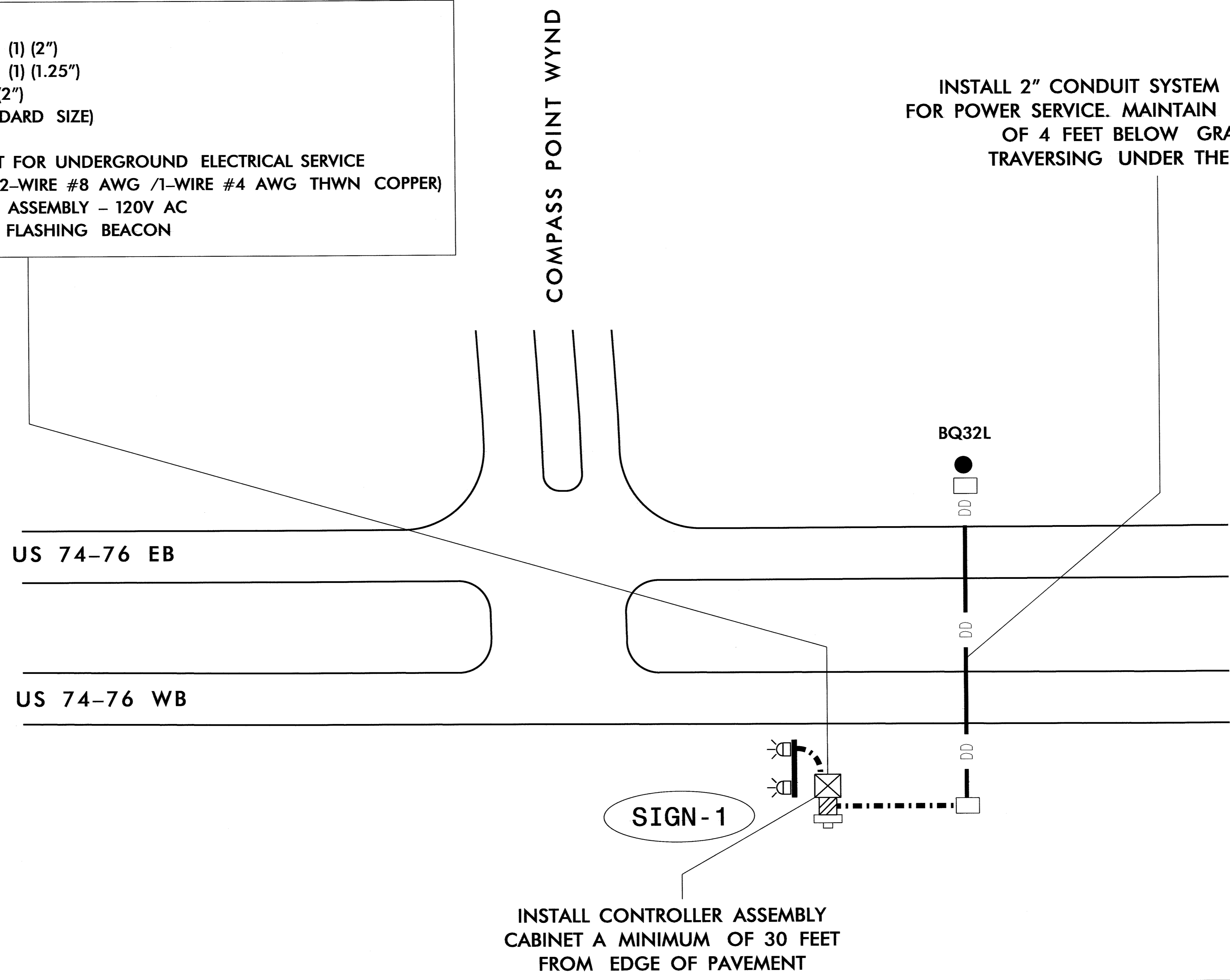

INSTALL 2" CONDUIT SYSTEM WITH PULL LINE FOR POWER SERVICE. MAINTAIN A MINIMUM DEPTH OF 4 FEET BELOW GRADE WHEN TRAVERSING UNDER THE ROADWAY.

INSTALL CONTROLLER ASSEMBLY CABINET A MINIMUM OF 30 FEET FROM EDGE OF PAVEMENT

NOTE: REFERENCE SIGNING PLANS FOR LOCATION OF SIGN STRUCTURE. OBTAIN ENGINEERS APPROVAL FOR FINAL LOCATION.

	<b>HIGHWAY ADVISORY RADIO FLASHING BEACON SIGN</b>		
	DIVISION 03    NEW HANOVER CO.    WILMINGTON		
PLAN DATE: APRIL 2012	REVIEWED BY: I. N. AVERY	PREPARED BY: S. C. WARDLE    REVIEWED BY: G. A. FULLER	
750 N. Greenfield Pkwy., Garner, NC 27529	SCALE: 0	REVISIONS	INIT.    DATE
CADD Filename:		SIGNATURE: <i>Gregory A. Fuller</i> DATE: 5/9/12	

INSTALL THE FOLLOWING	
QUANTITY	DESCRIPTION
1	WOOD POST (6" x 6")
110'	UNPAVED TRENCHING (1) (2")
30'	UNPAVED TRENCHING (1) (1.25")
1	ELECTRICAL SERVICE
2	2" CONDUIT STUB-OUT FOR UNDERGROUND ELECTRICAL SERVICE
140'	FEEDER CONDUCTOR (2-WIRE #8 AWG /1-WIRE #4 AWG THWN COPPER)
1	BEACON CONTROLLER ASSEMBLY - 120V AC
2	12", 1 SECTION AMBER FLASHING BEACON

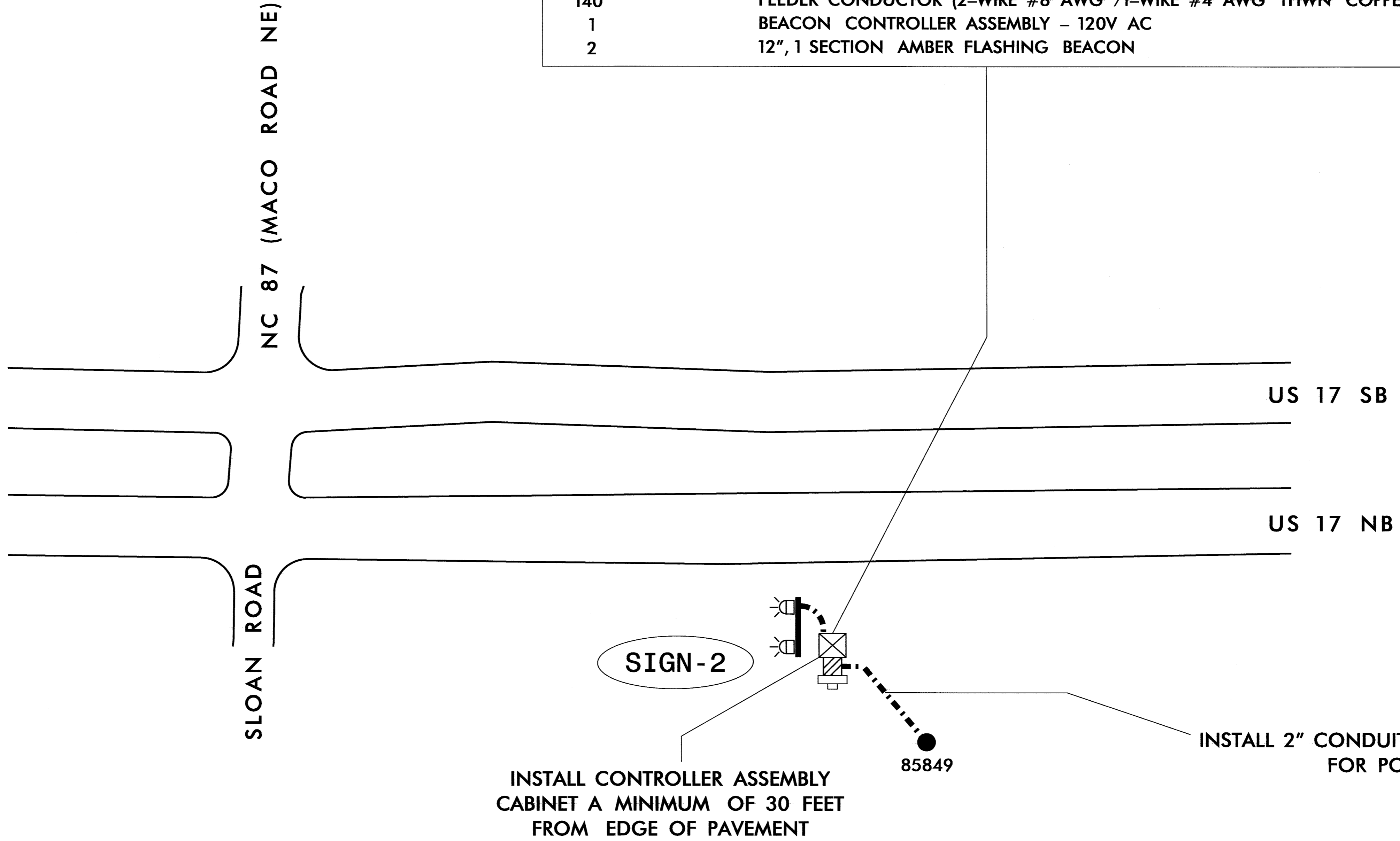

NOTE: REFERENCE SIGNING PLANS FOR LOCATION OF SIGN STRUCTURE. OBTAIN ENGINEERS APPROVAL FOR FINAL LOCATION.

	<b>HIGHWAY ADVISORY RADIO FLASHING BEACON SIGN</b>			
	DIVISION 03 NEW HANOVER CO. WILMINGTON			
	PLAN DATE: APRIL 2012	REVIEWED BY: I.N. AVERY		
	PREPARED BY: S.C. WARDLE	REVIEWED BY: G.A. FULLER		
SCALE 	REVISIONS	INIT.	DATE	
SIGNATURE: <i>Gregory A. Fuller</i>			DATE: 5/9/12	
CADD File name:				



INSTALL THE FOLLOWING	
QUANTITY	DESCRIPTION
1	WOOD POST (6" x 6")
300'	DIRECTIONAL DRILL (1) (2")
30'	UNPAVED TRENCHING (1) (1.25")
2	JUNCTION BOX (STANDARD SIZE)
1	ELECTRICAL SERVICE
2	2" CONDUIT STUB-OUT FOR UNDERGROUND ELECTRICAL SERVICE
330'	FEEDER CONDUCTOR (2-WIRE #8 AWG /1-WIRE #4 AWG THWN COPPER)
1	BEACON CONTROLLER ASSEMBLY - 120V AC
2	12", 1 SECTION AMBER FLASHING BEACON

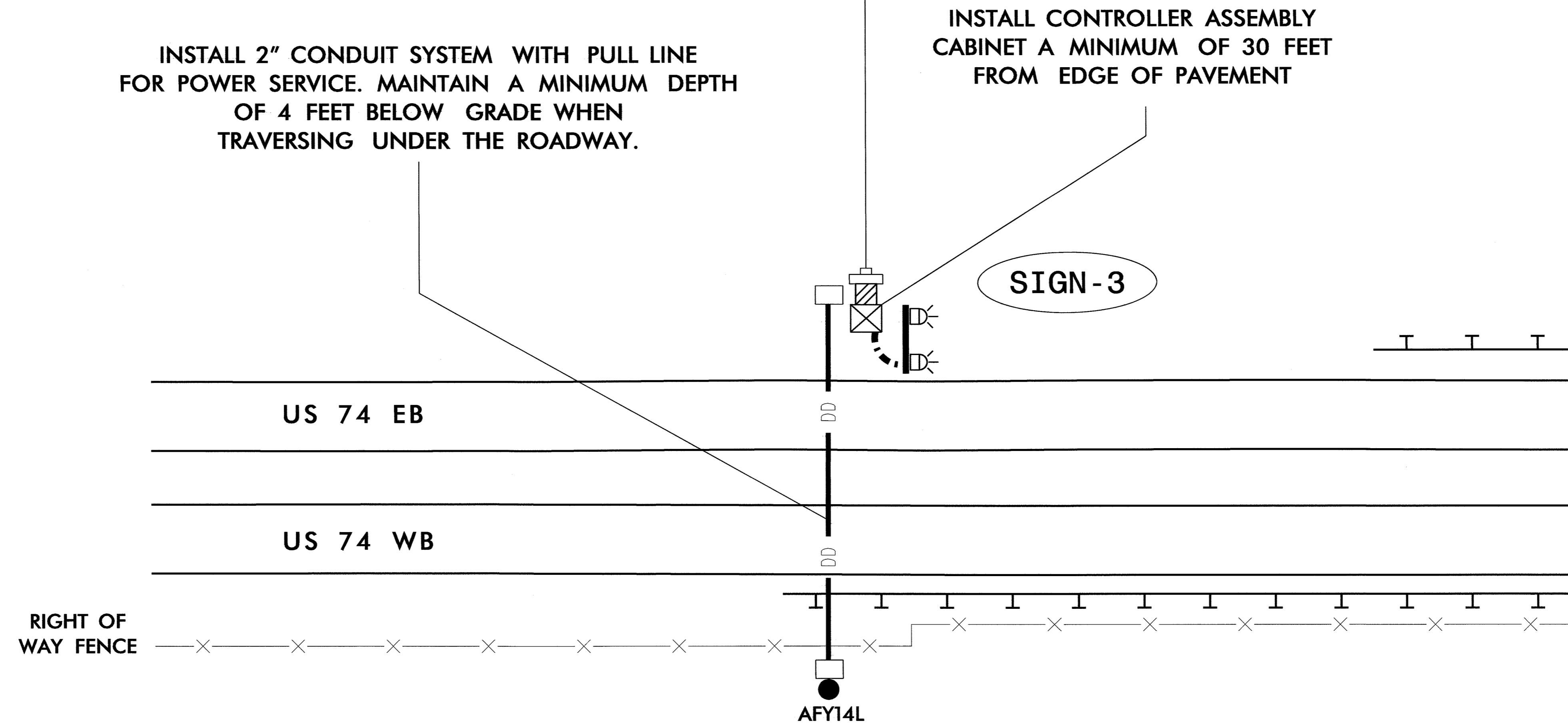

NOTE: REFERENCE SIGNING PLANS FOR LOCATION OF SIGN STRUCTURE. OBTAIN ENGINEERS APPROVAL FOR FINAL LOCATION.

	<b>HIGHWAY ADVISORY RADIO FLASHING BEACON SIGN</b>		
	DIVISION 03    NEW HANOVER CO.    WILMINGTON	PLAN DATE: APRIL 2012    REVIEWED BY: I.N. AVERY	
PREPARED BY: S.C. WARDLE	REVISIONS	REVIEWED BY: G.A. FULLER	INIT.    DATE
SCALE: 0'		SIGNATURE: <i>Gregory A. Fuller</i> DATE: 5/9/12	

CADD File name:

INSTALL THE FOLLOWING	
QUANTITY	DESCRIPTION
1	WOOD POLE (40')
30'	UNPAVED TRENCHING (1) (1.25")
1	1" RISER WITH WEATHERHEAD
1	BEACON CONTROLLER ASSEMBLY – SOLAR POWERED
2	12", 1 SECTION AMBER FLASHING BEACON

SOLAR PANEL

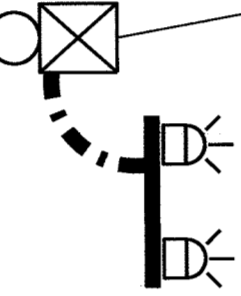
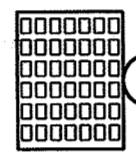

SIGN-4

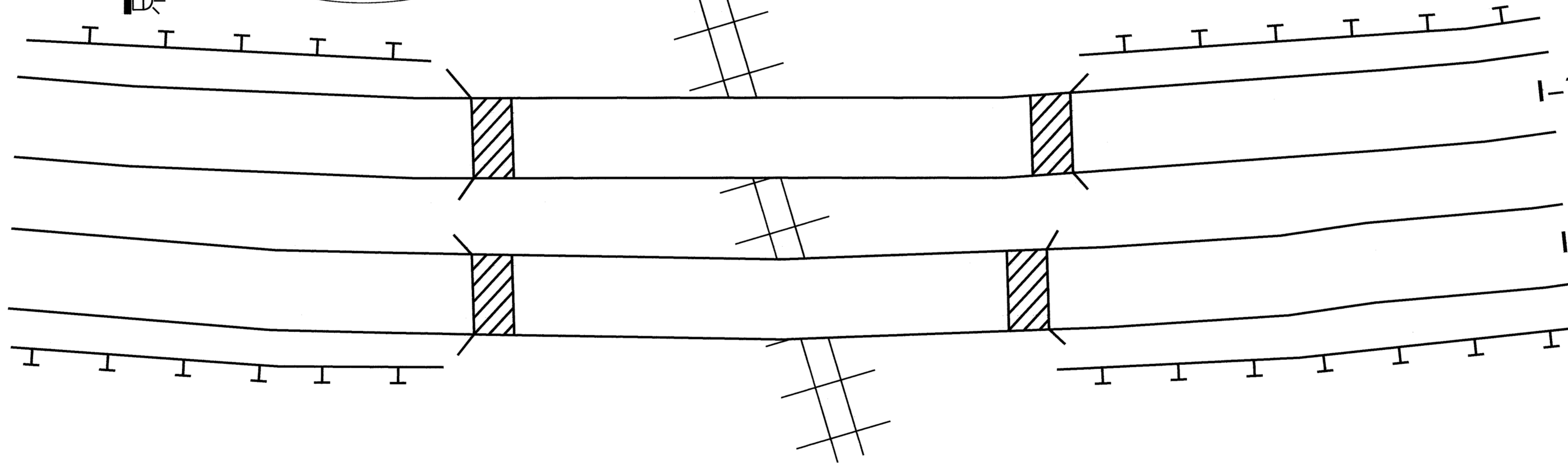

NOTE: REFERENCE SIGNING PLANS FOR LOCATION OF SIGN STRUCTURE. OBTAIN ENGINEERS APPROVAL FOR FINAL LOCATION.

	<b>HIGHWAY ADVISORY RADIO FLASHING BEACON SIGN</b>		
	DIVISION 03 NEW HANOVER CO. WILMINGTON		
	PLAN DATE: APRIL 2012	REVIEWED BY: I. N. AVERY	
	PREPARED BY: S. C. WARDLE	REVIEWED BY: G. A. FULLER	
SCALE: 0	REVISIONS	INIT.	DATE
		CADD filename:	

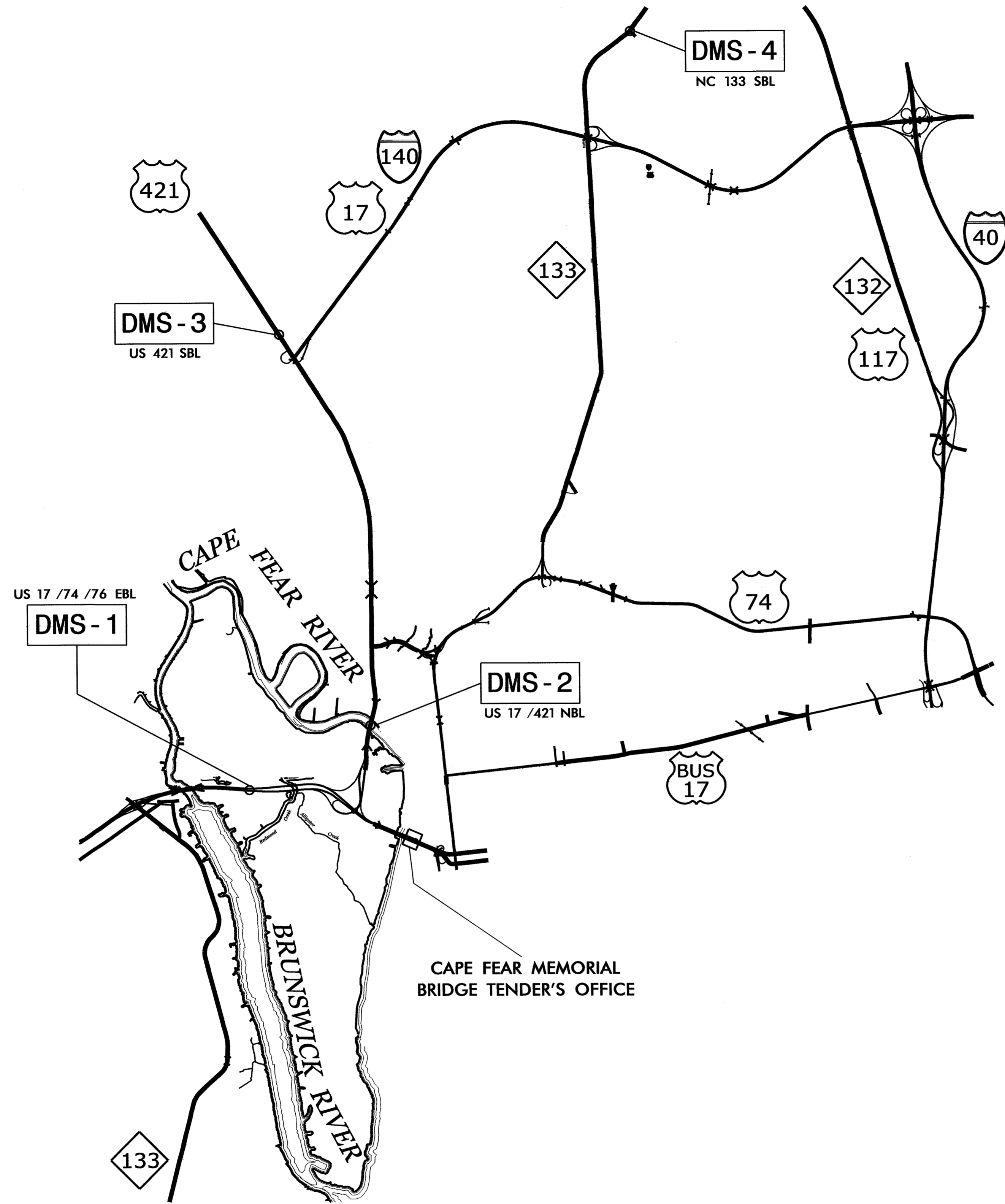

EXISTING DMS INTEGRATION:

MAKE MODIFICATIONS TO THE DMS SOFTWARE SET-UP PROGRAMMING AND ADD NEW MESSAGES RELATED TO THE HIGHWAY ADVISORY RADIO SYSTEM. MESSAGES TO BE OBTAINED FROM THE ENGINEER.

	<b>HIGHWAY ADVISORY RADIO EXISTING DMS INTEGRATION</b>		
	DIVISION 03    NEW HANOVER CO.    WILMINGTON		
750 N. Greenfield Hwy., Garner, NC 27529	PLAN DATE: APRIL 2012	REVIEWED BY: I.N. AVERY	SIGNATURE: <i>Gregory A. Fuller</i> DATE: 5/9/12
SCALE: 0 [Scale bar]	PREPARED BY: S.C. WARDLE	REVIEWED BY: G.A. FULLER	
REVISIONS		INIT.	DATE
CADD File name:			



INSTALL THE FOLLOWING	
QUANTITY	DESCRIPTION
1	CABINET FOUNDATION*
1	WOOD POLE (40')
75'	UNPAVED TRENCHING (1) (1")
100'	DIRECTIONAL DRILL (1) (2")
5	JUNCTION BOX (STANDARD SIZE) **
100'	FEEDER CONDUCTOR (2-WIRE #8 AWG /1-WIRE #4 AWG THWN COPPER)
1	2" RISER WITH WEATHERHEAD
1	AM TRANSMITTER STATION

\*NOTE: LOCATION OF NEW TYPE 332 CABINET TO BE APPROVED BY THE ENGINEER.  
 \*\*NOTE: INSTALL JUNCTION BOX (STANDARD SIZE) OVER EACH GROUND ROD IN TRIAD GROUNDING SYSTEM.

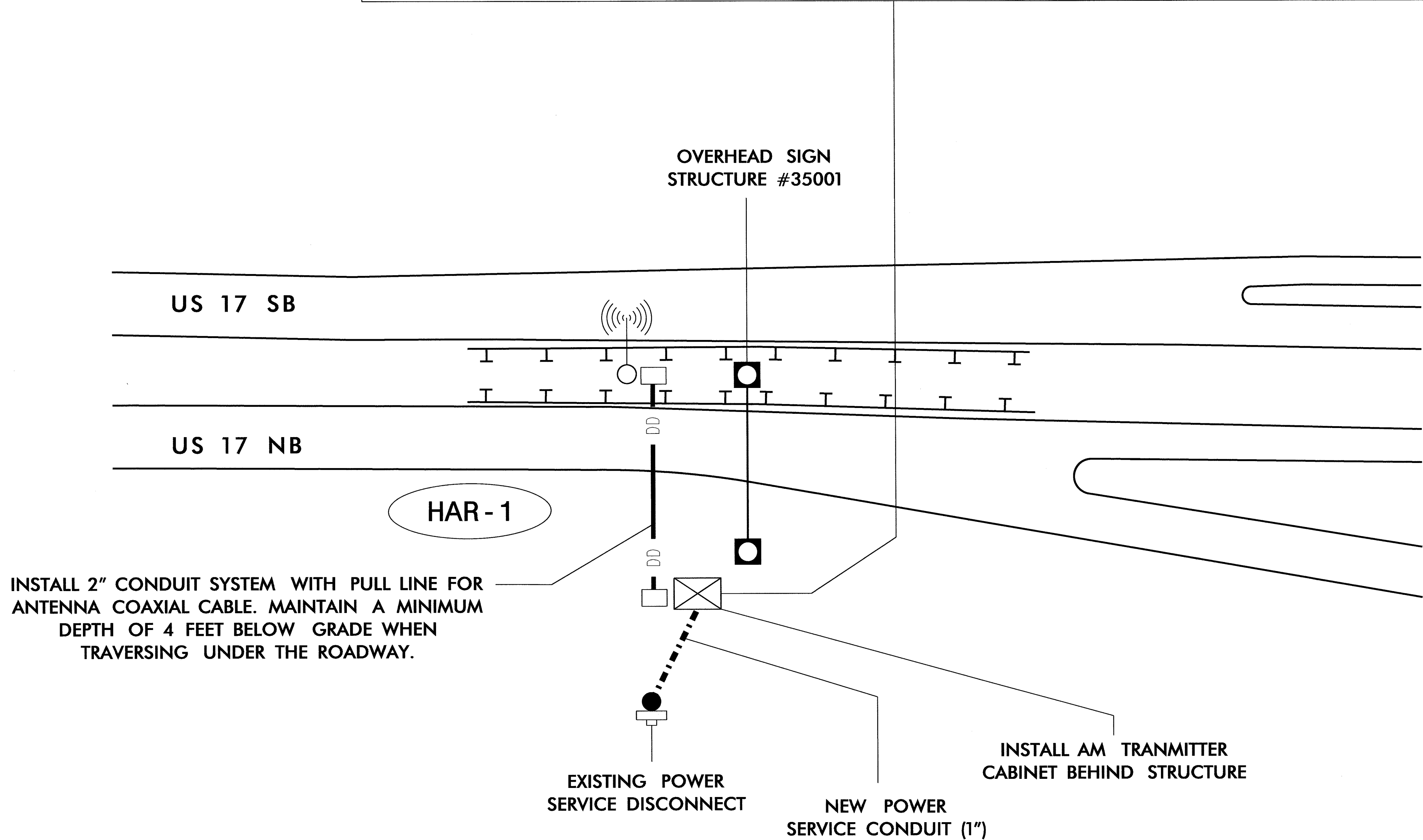

NOTE: REFERENCE "HIGHWAY ADVISORY RADIO, ELECTRICAL SERVICE AND GROUNDING DETAIL SHEETS" FOR INFORMATION PERTAINING TO INSTALLING THE TRIAD GROUNDING SYSTEM.

	<b>HIGHWAY ADVISORY RADIO AM TRANSMITTER STATION</b>		
	DIVISION 03    NEW HANOVER CO.    WILMINGTON	PLAN DATE: APRIL 2012    REVIEWED BY: I.N. AVERY	
750 N. Greenfield Pkwy., Garner, NC 27529	PREPARED BY: S.C. WARDLE	REVIEWED BY: G.A. FULLER	SIGNATURE: <i>Gregory A. Fuller</i> DATE: 5/1/12
SCALE: 0" = 10'	REVISIONS:	INIT.:	DATE:

INSTALL THE FOLLOWING	
QUANTITY	DESCRIPTION
1	CABINET FOUNDATION*
1	WOOD POLE (40')
75'	UNPAVED TRENCHING (1) (1")
3	JUNCTION BOX (STANDARD SIZE)
100'	FEEDER CONDUCTOR (2-WIRE #8 AWG /1-WIRE #4 AWG THWN COPPER)
1	2" RISER WITH WEATHERHEAD
1	AM TRANSMITTER STATION

\*NOTE: LOCATION OF NEW TYPE 332 CABINET TO BE APPROVED BY THE ENGINEER.  
 \*\*NOTE: INSTALL JUNCTION BOX (STANDARD SIZE) OVER EACH GROUND ROD IN TRIAD GROUNDING SYSTEM.

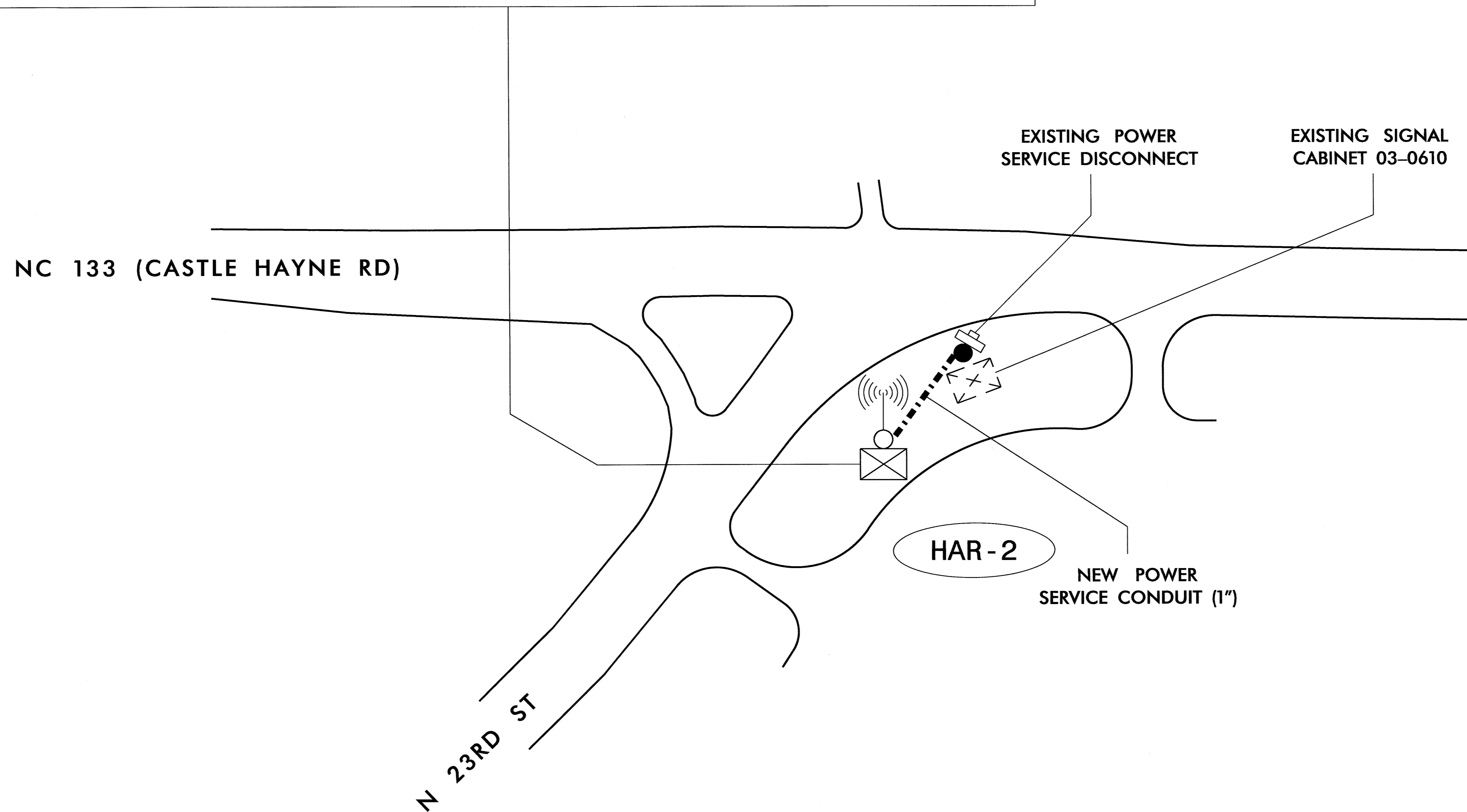

NOTE: REFERENCE "HIGHWAY ADVISORY RADIO, ELECTRICAL SERVICE AND GROUNDING DETAIL SHEETS" FOR INFORMATION PERTAINING TO INSTALLING THE TRIAD GROUNDING SYSTEM.

	<b>HIGHWAY ADVISORY RADIO AM TRANSMITTER STATION</b>		
	DIVISION 03    NEW HANOVER CO.    WILMINGTON		
PREPARED BY: S.C. WARDLE 750 N. Greenfield Pkwy., Garner, NC 27529	PLAN DATE: APRIL 2012 REVISIONS:	REVIEWED BY: I.N. AVERY REVIEWED BY: G.A. FULLER	SEAL PROFESSIONAL ENGINEER GREGORY A. FULLER No. 023919 CATEGORY A
	SCALE: 0	REVISIONS:    INIT.    DATE	SIGNATURE: <i>Gregory A. Fuller</i> DATE: 5/9/12

T.I.P.: R-4049

**STATE OF NORTH CAROLINA  
DEPARTMENT OF TRANSPORTATION**

**SIGNING PLAN  
BRUNSWICK COUNTY AND NEW HANOVER COUNTY**

**LOCATION: HIGHWAY ADVISORY RADIO SIGNS AND FLASHING BEACON IN WILMINGTON  
(US-74 /US-76 EBL, US-17 NBL, US-74 WBL, AND I-140 WBL /US-17 SBL)**

TIP NO. R-4049	SHEET NO. SIGN-1
APPROVED:	
DATE: 5/8/12	
SEAL 	

**ROADWAY STANDARD DRAWING**

THE FOLLOWING ROADWAY STANDARDS AS APPEAR IN "ROADWAY STANDARD DRAWINGS" - PROJECT SERVICES UNIT - N.C. DEPARTMENT OF TRANSPORTATION - RALEIGH, N.C., DATED JANUARY 2012 ARE APPLICABLE TO THIS PROJECT AND BY REFERENCE HEREBY ARE CONSIDERED A PART OF THESE PLANS:

STD. NO.	TITLE
901.10	TYPE 'A' SIGNS
901.70	SIGN STRINGERS AND SUPPORT SPACING
901.80	SIGN MOUNTING DETAILS
903.10	GROUND MOUNTED SIGN SUPPORTS
904.10	ORIENTATION OF GROUND MOUNTED SIGNS

**PROJECT NOTES**

- SEE ITS PLANS FOR FLASHING BEACON DETAILS AND SPECIAL PROVISION.
- VERIFY RADIO CHANNEL PRIOR TO SIGN FABRICATION.

**SUMMARY OF QUANTITIES**

ITEM NO.		ITEM DESCRIPTION	QUANTITY	UNIT
DESC. NO.	SECT. NO.			
0001000000	800	MOBILIZATION	1	L.S.
4026000000	901	DEPARTMENT FURNISHED, TYPE A SIGN	312	S.F.
4048000000	902	REINFORCED CONCRETE SIGN FOUNDATIONS	4	C.Y.
4060000000	903	SUPPORTS, BREAKAWAY STEEL BEAM	2408	LB.
4066000000	903	SUPPORTS, SIMPLE STEEL BEAM	649	LB.
4110000000	904	SIGN ERECTION, TYPE A (GROUND MOUNTED)	4	EA.

**GENERAL NOTES**

-SIGNS FURNISHED BY STATE

**INDEX**

SHEET NO.	DESCRIPTION
SIGN-1	TITLE SHEET
SIGN-2	SUPPORTS INFORMATION
SIGN-3	SIGN DESIGNS
SIGN-4	SIGN DETAIL SHEET

PLAN PREPARED BY: N.C.D.O.T. SIGNING AND DELINEATION UNIT

AYMAN ALQUDWAH, PE, CPM, SIGNING & DELINEATION REGIONAL ENGINEER  
BASIR A. RASHID SIGNING & DELINEATION PROJECT DESIGN ENGINEER



C:\MSD1\2012\1450\03\01\Reg\Sign\Basir\Basir-R-4049\_HARS-D\wstcom-3\R-4049\_Sgn\_Sheet1-3.dgn  
DATE: 5/8/12  
BY: brashid

TIP NO. R-4049	SHEET NO. SIGN-2
APPROVED: <i>[Signature]</i>	
DATE: 5/8/12	
SEAL	

SIGN NO.	SIGN TYPE	SIGN SIZE (in.)	ROADWAY STATION	NO. OF SUP.	BEAM SECTION	SUPPORT TYPE	ATTACH METHOD	MOUNTING METHOD	LENGTH (ft)				LEFT SUPPORT (ft)		CENTER SUPPORT (ft)		RIGHT SUPPORT (ft)		FOOTING DIAMETER (ft.)	FOOTING DEPTH (ft.)	B/A SUPPORT WEIGHTS (lbs.)	SIMPLE SUPPORT WEIGHTS (lbs.)	REINF. FTGS. (c.y.)	PLAIN FTGS. (c.y.)	FIELD VERIFIED SEE NOTE 2 (mm/dd/yy)			
									CLR. (ft.)	SNS HT (ft.)	MTG HT (ft.)	EMBED-MENT (ft.)	S	L	S	L	S	L								S	L	S
1	A	144 X78	US-74/76 EBL **	2	W6x16	BA	N/A	N/A	20.00	6.50	7.00	5.5	2.70	16.20	21.70	0.00	0.00	0.00	2.45	15.95	21.45	1.5	6	822.78	0.00	0.79	0.00	
2	A	144 X78	US-17 NBL **	2	W6x16	BA	N/A	N/A	30.00	6.50	7.00	5.5	3.10	16.60	22.10	0.00	0.00	0.00	2.70	16.20	21.70	1.5	6	833.18	0.00	0.79	0.00	
3	A	144 X78	US-74 WBL **	2	W6x16	BA	N/A	N/A	25.00	6.50	10.50	5.5	-2.80	14.20	19.70	0.00	0.00	0.00	-3.50	13.50	19.00	1.5	6	751.58	0.00	0.79	0.00	
4	A	144 X78	I-140 WB/US-17 SB **	2	W6x16	S	N/A	N/A	18.00	6.50	7.00	5	1.10	14.60	19.60	0.00	0.00	0.00	2.40	15.90	20.90	1.5	5.5	0.00	648.00	0.72	0.00	
																					TOTAL	TOTAL	TOTAL	TOTAL				
																					2407.54	648.00	3.09	0.00				
USE:																					2408	649	4	0				

\*\* SEE SIGNING DETAIL SHEET

**NOTES**

- DIMENSION "S" REPRESENTS AN INCREASE (+), OR A DECREASE (-) IN POLE LENGTH, RELATIVE TO THE ELEVATION OF THE EDGE OF PAVEMENT.
- FIELD VERIFICATIONS SHALL BE REQUIRED FOR ALL SUPPORTS, SEE (\*) ARTICLE 903-3. FABRICATORS SHALL BE AISC CERTIFIED IN CATEGORY 1, SEE (\*) ARTICLE 1072-1. (\*) = N.C.D.O.T. STANDARD SPECIFICATIONS FOR ROADS AND STRUCTURES
- PLAN LOCATIONS FOR EXISTING UTILITIES ARE BASED ON THE BEST AVAILABLE INFORMATION AND, THEREFORE MAY NOT BE PRECISELY ACCURATE. THEREFORE, IT IS INCUMBENT UPON THE CONTRACTOR TO DETERMINE THE EXACT LOCATION OF UTILITIES BEFORE BEGINNING WORK IN A LOCATION.

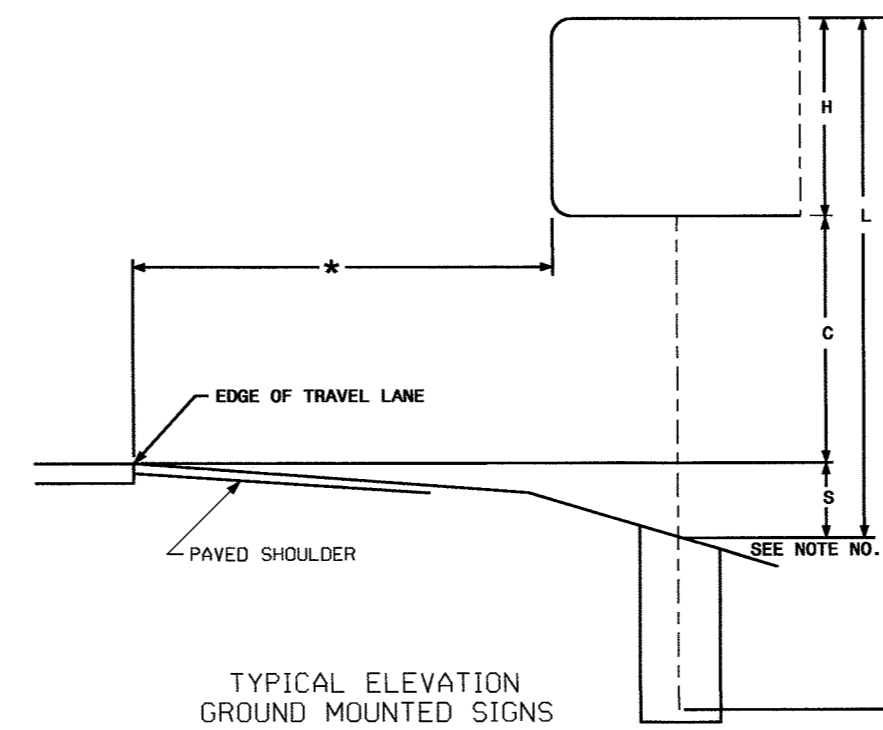

**SIGN DESIGNS  
TYPE "A" SIGNS (GROUND MOUNTED)**

08-MAY-2012 07:42:59 \\Basir\Projects\4049\_HAR\S-Division-3\R-4049\_Sgn-Sheet-1-3.dgn

TIP NO. R-4049	SHEET NO. SIGN 3
APPROVED: <i>[Signature]</i>	
DATE: 5/8/12	
SEAL	

SIGN NUMBER: 1,2,3,4  
 TYPE: A  
 QUANTITY: 4  
 SIGN WIDTH: 12'-0"  
 HEIGHT: 6'-6"  
 TOTAL AREA: 78.0 Sq.Ft.  
 BORDER TYPE: FLUSH  
 RECESS: 0"  
 WIDTH: 1.5"  
 RADII: 9"  
 NO. Z BARS: 2  
 LENGTH: 136.0

BACKG COLOR: Blue/Yellow  
 COPY COLOR: White/Black

SYMBOL	X	Y	WID	HT

MAT'L: 0.125" (3.2 mm) ALUMINUM

DESIGN BY: B. RASHID  
 PROJECT ID: R-4049  
 CHECKED BY:  
 DIV: 3  
 DATE: March 27, 2012

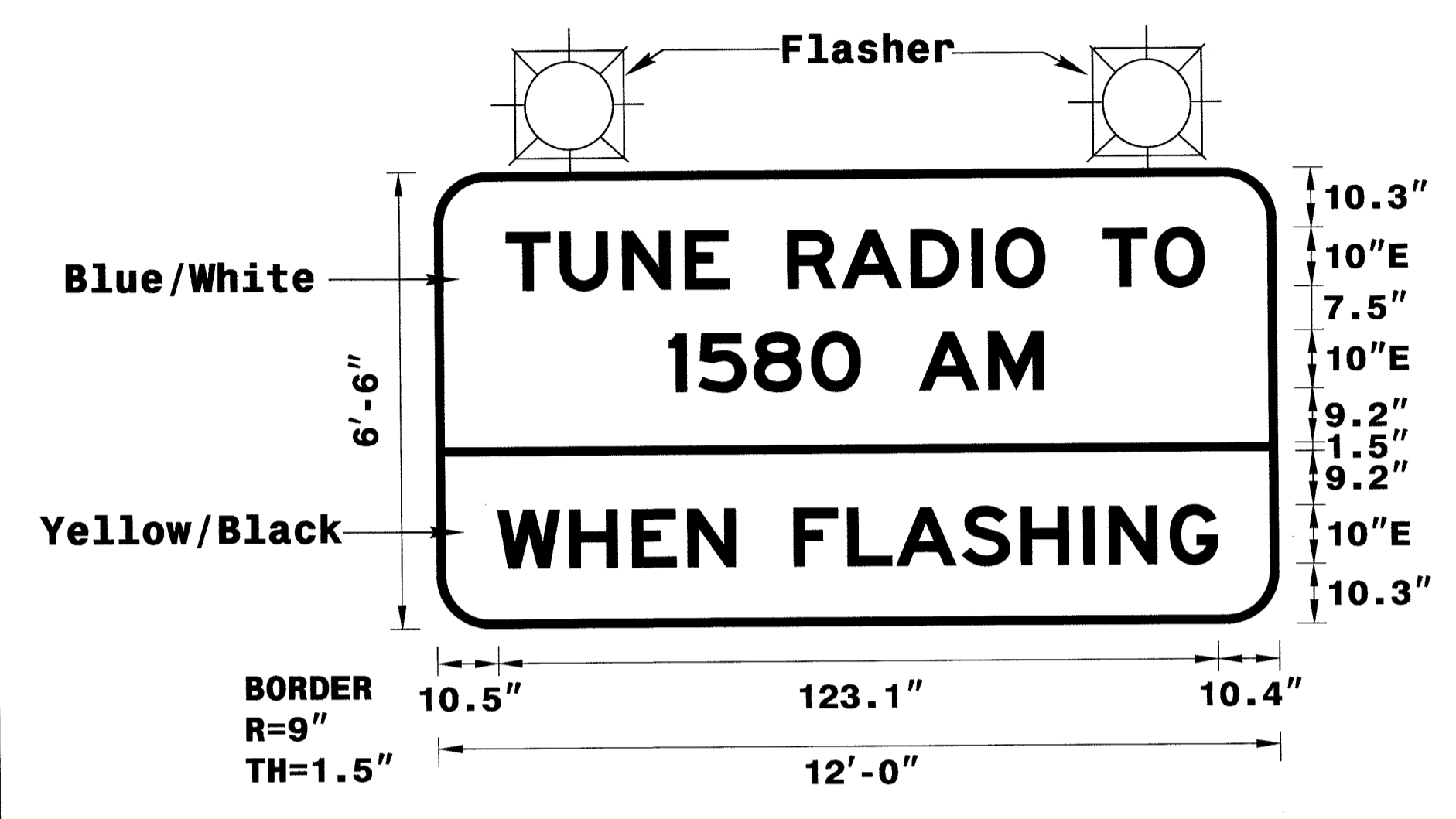

- USE NOTES: 1,2,3,4
- Legend and border(except those that are colored black) shall be direct applied Grade C sheeting.
  - Background shall be Grade C reflective sheeting.
  - See ITS Plan for Flashing Beacon details.
  - Verify Radio Channel prior to sign fabrication.

LETTER POSITIONS

Letter spacings are to start of next letter														Series/Size		
														Text Length		
	T	U	N	E		R	A	D	I	O		T	O			E 2000
12.3	9.2	10.7	10.7	7.5	10	9.2	11.9	10.4	4.1	8.4	10	8.9	8.4	12.3		119.4
	1	5	8	0		A	M									E 2000
40	5	9.5	9.8	8.4	10	11.9	9.4	40								64
	W	H	E	N		F	L	A	S	H	I	N	G			E 2000
10.5	12.3	10.7	9.5	8.1	10	9.2	8.3	11.3	10.1	10.7	4.4	10.4	8.1	10.4		123.1

FILENAME: HAR\_Tune Radio To

NORTH CAROLINA D.O.T. SIGN DETAIL

TYPE "A" GROUND MOUNTED SIGNS  
 SUPPORTS INFORMATION

08-MAY-2012 07:44 S:\S&DU\Regions\Sigs\Baser\N-R-4049\_HAR\S-Division-3\N-R-4049\_Sgn\_Sheet1-3.dgn b.rashid



**PROJECT NOTES**

- SEE ITS PLANS FOR FLASHING BEACON DETAILS.
- VERIFY RADIO CHANNEL PRIOR TO SIGN FABRICATION.

TIP NO. R-4049	SHEET NO. SIGN-4
APPROVED: <i>[Signature]</i>	
DATE: 5/8/12	
SEAL	

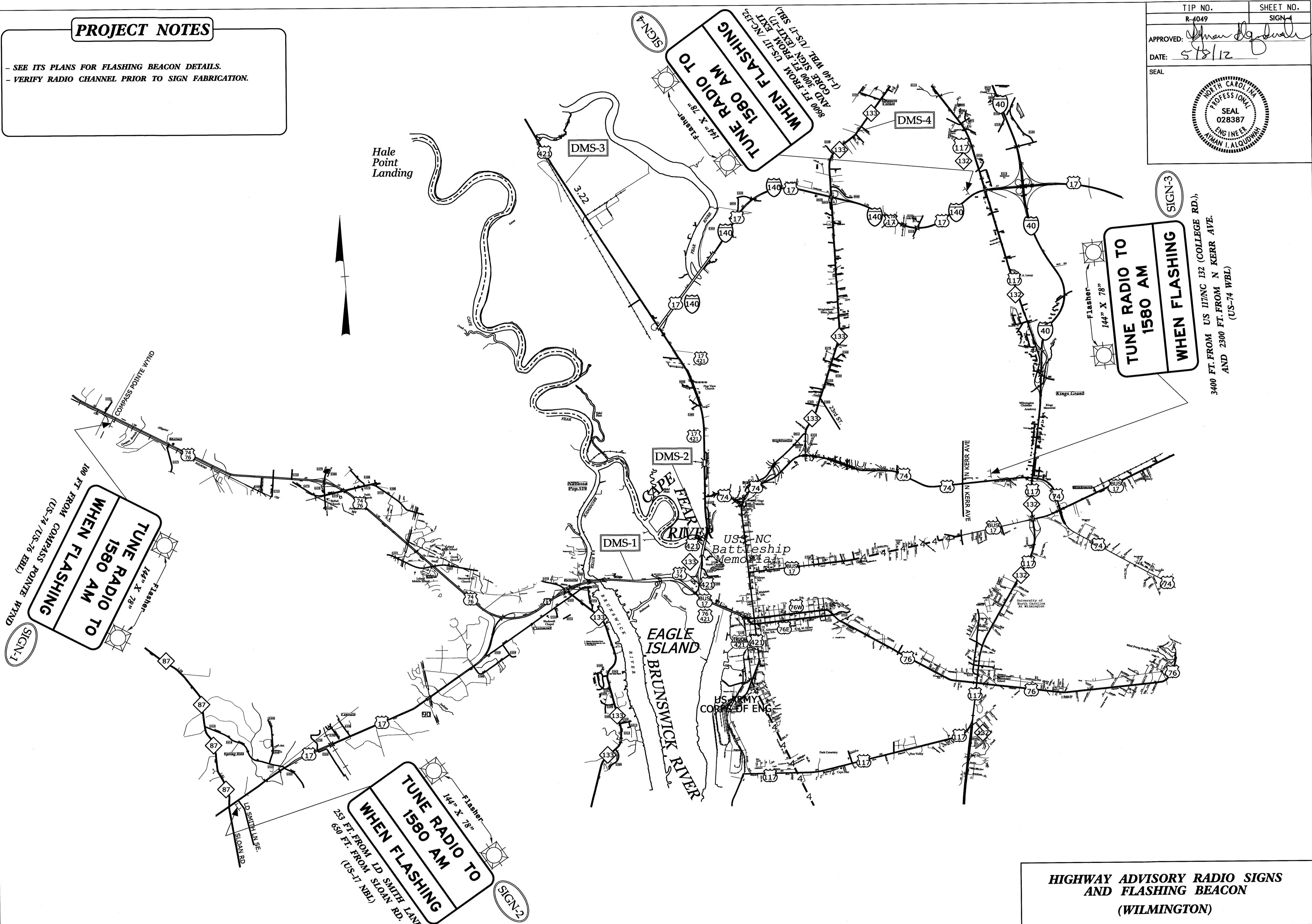

08-MAY-2012 07:38 C:\S&P\Region3\Signing\Basin\4049\_HAR\S-Division-3\Wilmington\_Signing\_two\_radios\_Sheet-4.dgn

**HIGHWAY ADVISORY RADIO SIGNS  
AND FLASHING BEACON  
(WILMINGTON)**